

Features

- Polycrystalline silicon
- Maximum power point 20W
- As a power source for traffic signs, LED etc.



Specification

| MODEL | DB020-12 |
|------------------------------------|--------------|
| Maximum Power Point (Pmax) | 20W |
| Maximum Power Point Voltage (Vmpp) | 17.0Vdc |
| Maximum Power Point Current (Impp) | 1.18A |
| Open Circuit Voltage (Voc) | 21.6Vdc |
| Short Circuit Current (Isc) | 1.25A |
| Dimensions (DxWxH) | 35x538x350mm |
| Weight | 2.6kg |

Dimensions

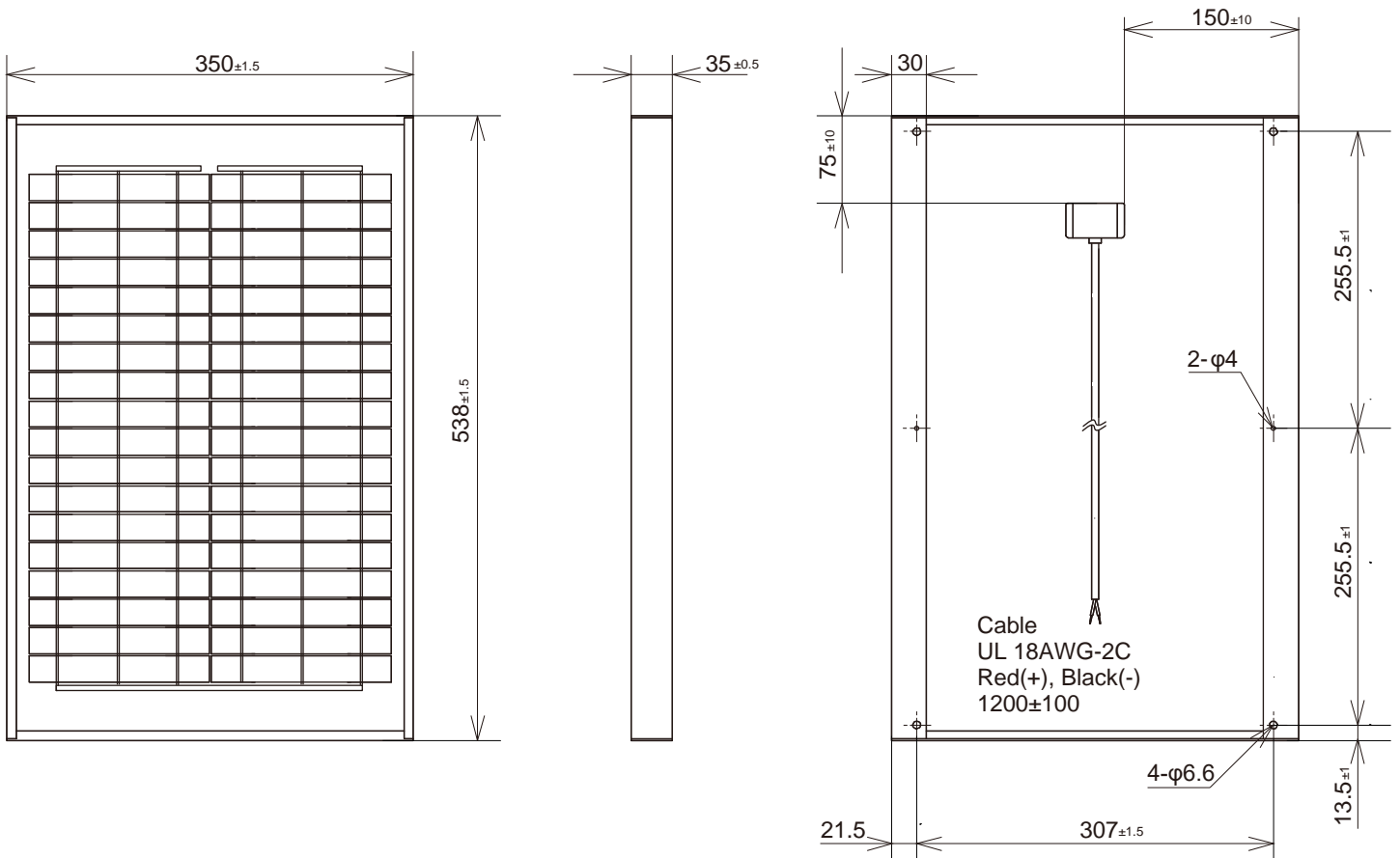

Unit [mm]